



-  PCB-Luft kleiner als 300 ng/m^3
-  PCB-Luft zwischen 300 und 3.000 ng/m^3

EBENE 0



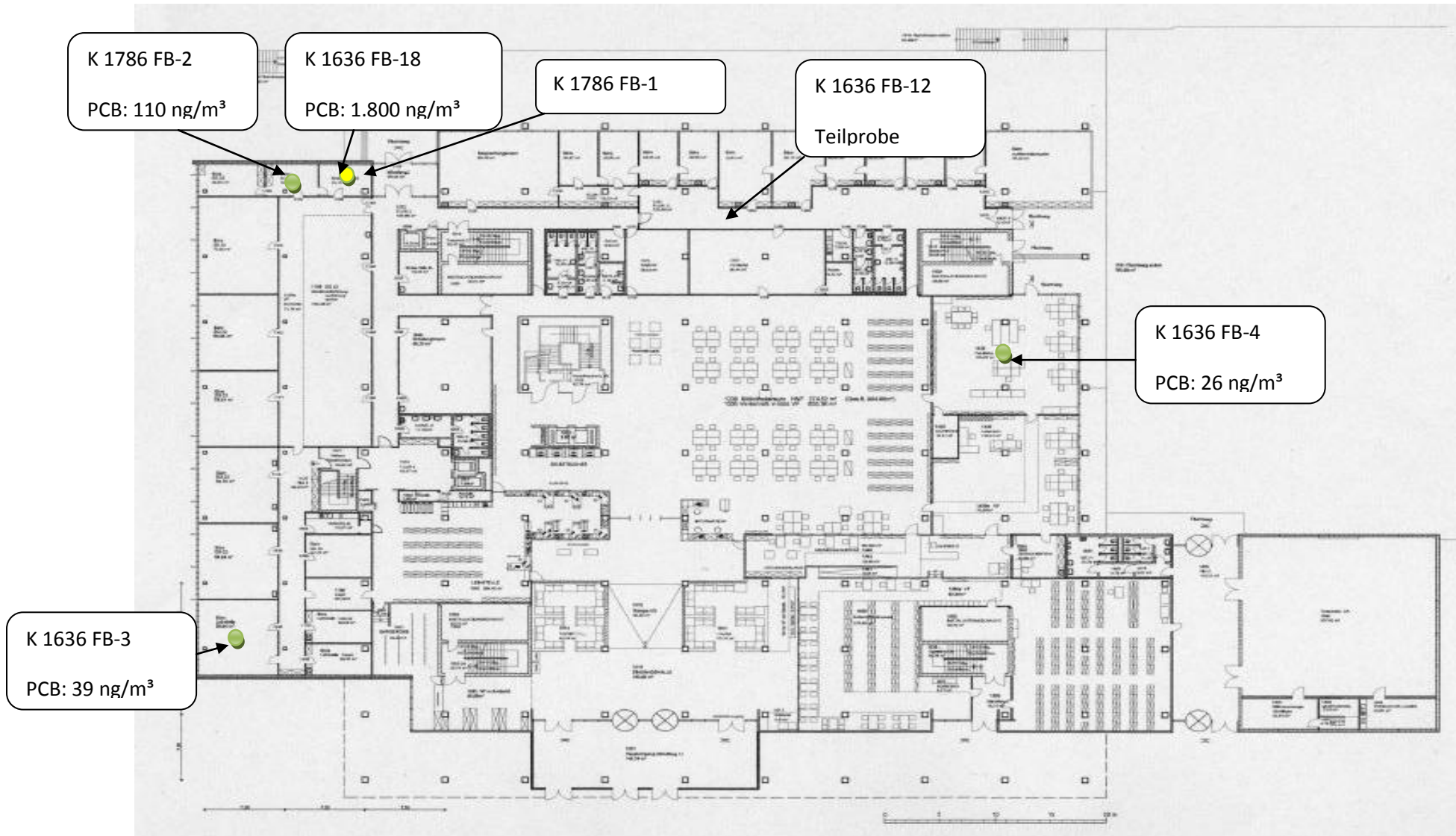

- PCB-Luft kleiner als 300 ng/m³
- PCB-Luft zwischen 300 und 3.000 ng/m³

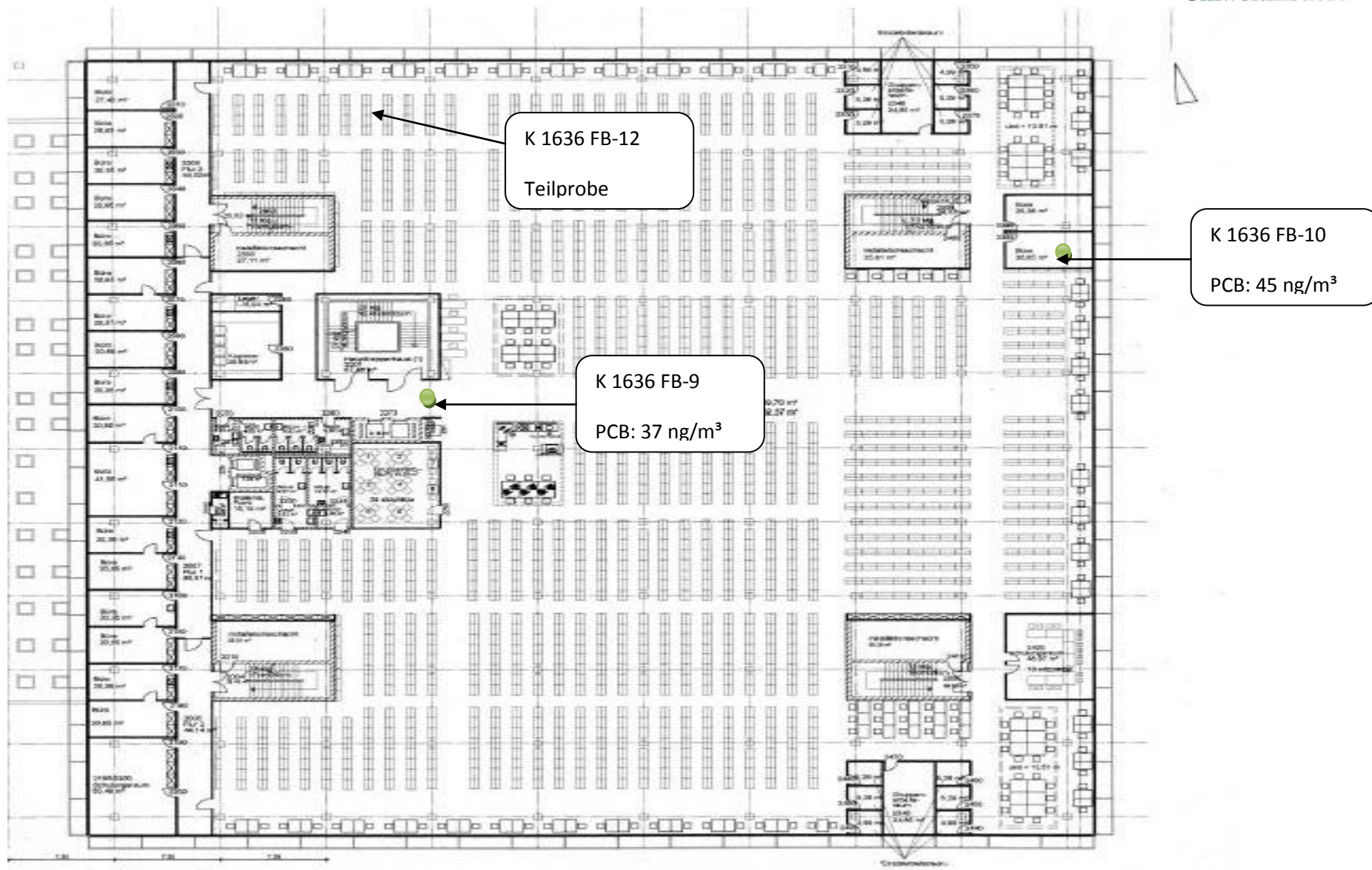
EBENE 1

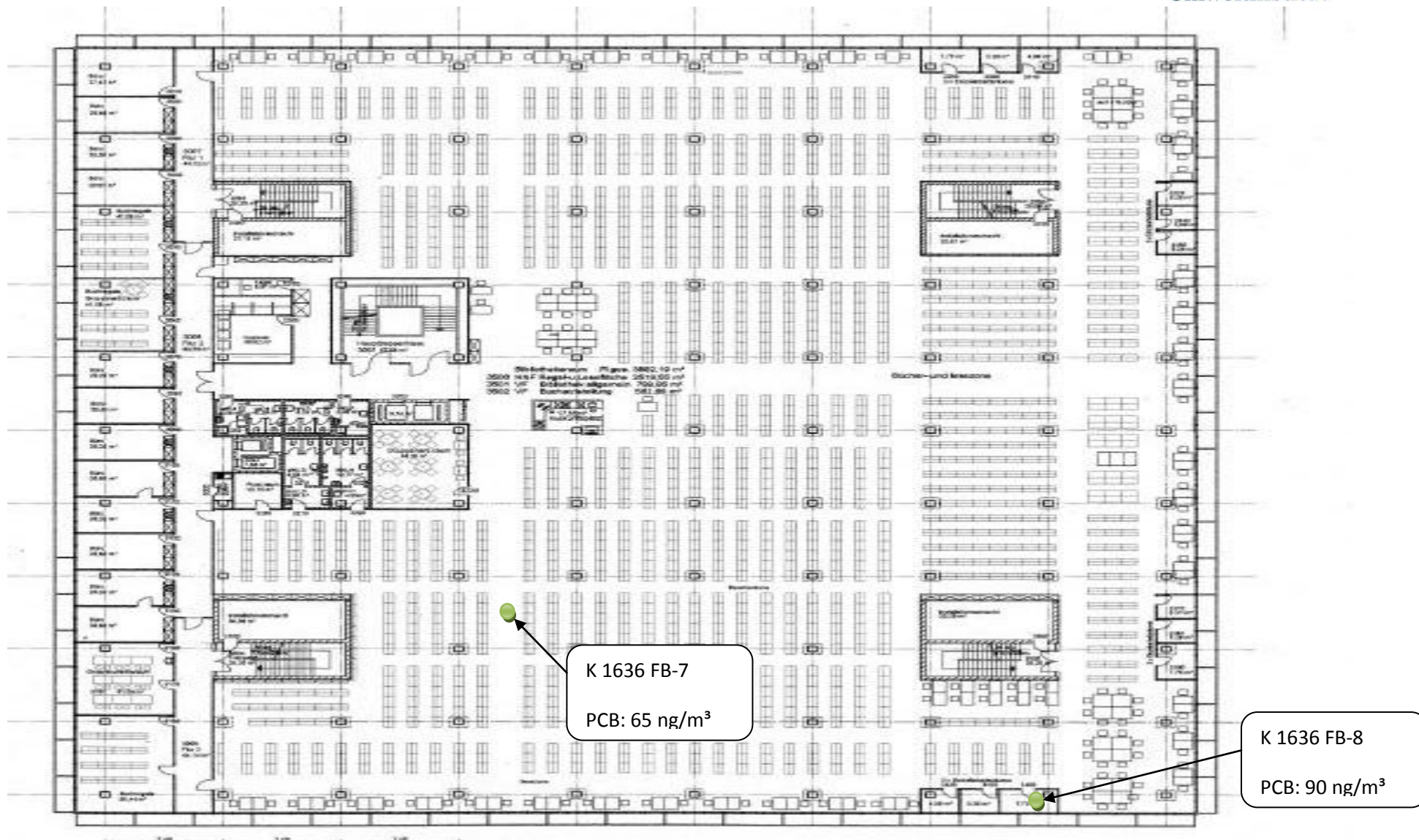



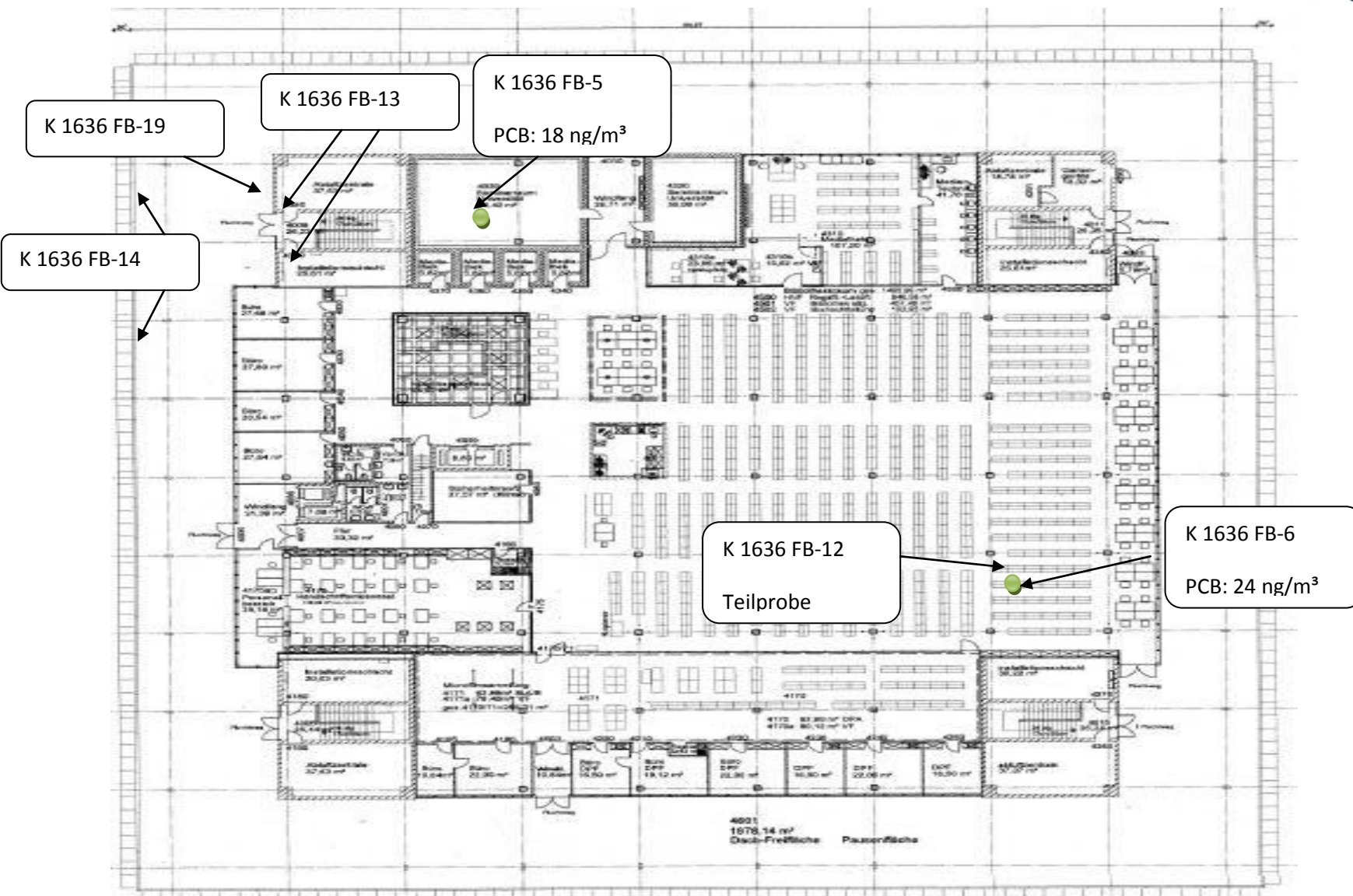

-  PCB-Luft kleiner als 300 ng/m^3
-  PCB-Luft zwischen 300 und 3.000 ng/m^3

EBENE 3



-  PCB-Luft kleiner als 300 ng/m³
-  PCB-Luft zwischen 300 und 3.000 ng/m³

EBENE 4